



Product Installation Guidelines

Version 1.2, 11 March 2025, Page 1 of 8
Document No.: 001.00.60.02

ProLab® EC-BS Lead Safe Lab Set Tapware



PRODUCTS

Item Code	Description	WELS Rating	Water Consumption	Nominal Flow Rate	Outlet
165.80.01.40	ProLab® EC-BS Lead Safe™ Bench Mtd Lab Set 1-Way Swivel Gooseneck N/V #16XT Tube Nozzle	5	6.0	5.6	Tube Nozzle
165.80.11.40	ProLab® EC-BS Lead Safe™ Bench Mtd Lab Set 1-Way Fixed Gooseneck N/V #16XT Tube Nozzle	5	6.0	5.6	Tube Nozzle
165.80.21.40	ProLab® EC-BS Lead Safe™ Bench Mtd Lab Set 1-Way R/Angle N/V #16XT Tube Nozzle	5	6.0	5.6	Tube Nozzle
165.80.31.40	ProLab® EC-BS Lead Safe™ Bench Mtd Lab Set 2-Way Swivel Gooseneck N/V #16XT Tube Nozzle	5	6.0	5.6	Tube Nozzle
165.80.51.40	ProLab® EC-BS Lead Safe™ Bench Mtd Lab Set 2-Way R/Angle N/V #16XT Tube Nozzle	5	6.0	5.6	Tube Nozzle
165.80.61.40	ProLab® EC-BS Lead Safe™ Bench Mtd Lab Set 3-Way Swivel Gooseneck N/V #16XT Tube Nozzle	5	6.0	5.6	Tube Nozzle
165.80.63.40	ProLab® EC-BS Lead Safe™ Bench Mtd Lab Set H&C 3-Way Swivel Gooseneck N/V #16XT Tube Nozzle	5	6.0	5.6	Tube Nozzle
165.81.01.40	ProLab® EC-BS Lead Safe™ Bench Mtd Lab Set Dual H&C 1-Way Swivel Gooseneck N/V #16XT Tube Nozzle	5	6.0	5.6	Tube Nozzle
165.82.01.40	ProLab® EC-BS Lead Safe™ Bench Lab Set Front H&C 1-Way Swivel Gooseneck N/V #16XT Tube Nozzle	5	6.0	5.6	Tube Nozzle
165.82.02.40	ProLab® EC-BS Lead Safe™ Bench Mtd Lab Set Front H&C 1-Way Swivel Gooseneck N/V #1 Aerator	5	6.0	5.6	Aerator
165.83.01.40	ProLab® EC-BS Lead Safe™ Bench Mtd Lab Set Side H&C 1-Way Swivel Gooseneck N/V #16XT Tube Nozzle	5	6.0	5.6	Tube Nozzle
165.84.01.40	ProLab® EC-BS Lead Safe™ Wall Mtd Lab Set 1-Way Swivel Gooseneck N/V #16XT Tube Nozzle	5	6.0	5.6	Tube Nozzle
165.84.11.40	ProLab® EC-BS Lead Safe™ Wall Mtd Lab Set 1-Way Fixed Gooseneck N/V #16XT Tube Nozzle	5	6.0	5.6	Tube Nozzle
165.87.01.40	ProLab® EC-BS Lead Safe™ Wall Mtd Lab Set Side H&C 1-Way Swivel Gooseneck N/V #16XT Tube Nozzle	5	6.0	5.6	Tube Nozzle

SPECIFICATIONS

- Polyester powder coating provides better chemical UV light and heat resistance than chrome plating.
- Specialised needle valve top assemblies give precise flow and regulation.
- Vandal resistant fittings are standard which are suitable for both educational and research labs.
- Quality controlled - every tap is tested.
- Tube nozzles or aerators are available on all water units.
- Exchangeable nozzles for flexible choice of outlet connection.
- Lead Safe™ brass construction*.

IMPORTANT: All laboratory taps are tested in accordance with AS 3718 and leave our premises in good working order.

*Our Lead Safe™ product range is compliant with the Lead Free Requirements of the NCC 2022 Vol. Three, Clause A5G4(2) and NSF/ANSI 372.

**Any flow controller incorporated in the outlet to be tightened to prevent removal by hand. As Per AS3718.

WARNINGS: Special attention to be paid on notes, photos, images, or drawings of assembly steps marked with the warning symbol.

**TECHNICAL DATA**

Inlet		G ½ – Male (Bench Mounted)	
		G ½ – Female (Wall Mounted)	
Headwork		Needle Valve	
Working Pressure Range (kPa)	Min	50	
	Max	500	
Working Temperature Range (°C)	Min	5	
	Max	60	
Construction		Brass	
Finish		Epoxy	
NOTE: Galvin Engineering continually strive to improve their products. Specifications may change without notice.			

TOOLS REQUIRED

- Power drill
- Spanner or adjustable crescent
- Thread tape / sealant

PRE-INSTALLATION – MOUNTING DETAILS

- Before installation, all lines must be flushed.
- Galvin Engineering recommends the installation of strainers and pressure reducing valves (when necessary) to ensure clean consistent supply. Debris or poor water quality could affect the performance of the unit.
- If the mounting hole does not exist, mark out and drill the holes on the bench or the wall, as shown in rough-in dimensions.

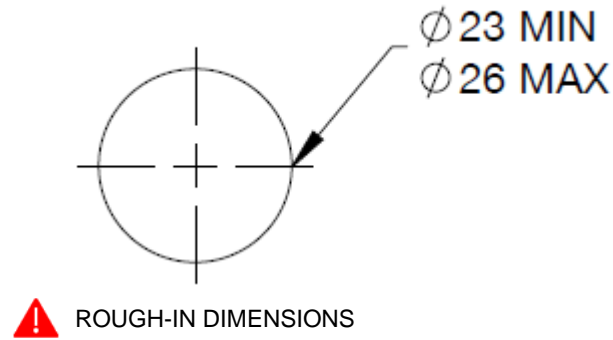

DIMENSIONS

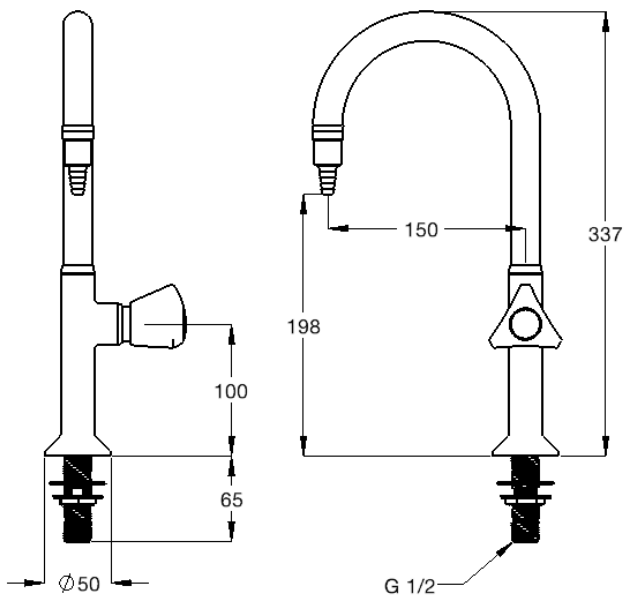

165.80.01.40

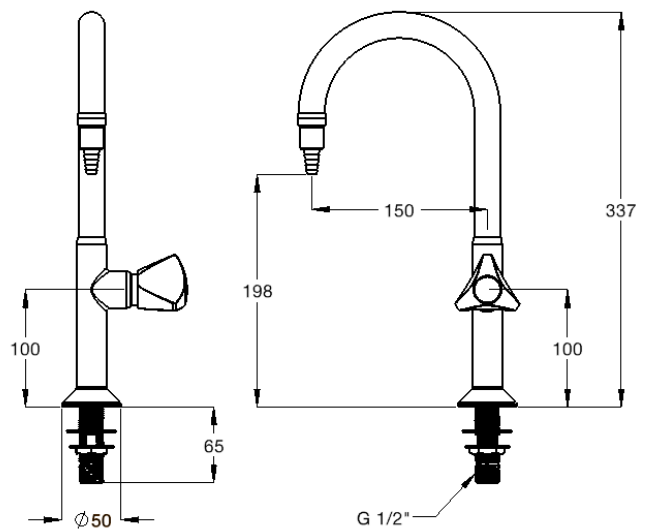

165.80.11.40

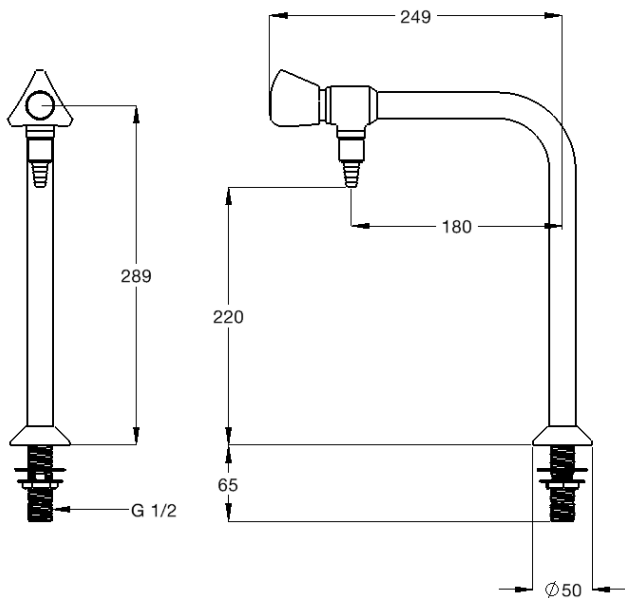

165.80.21.40

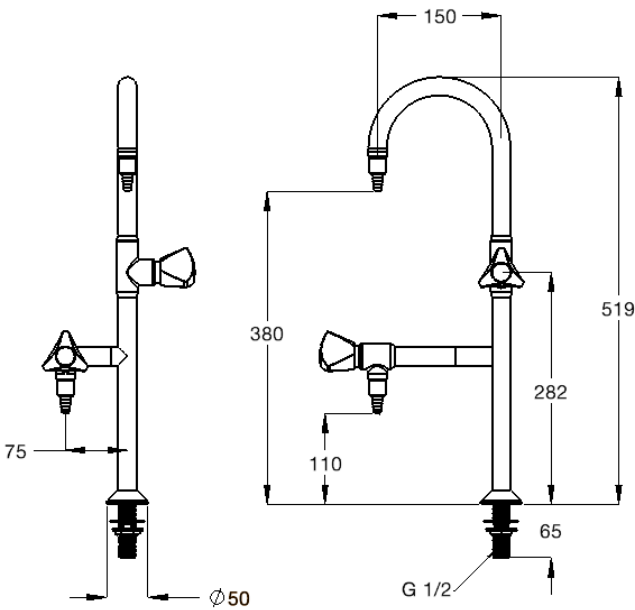

165.80.31.40

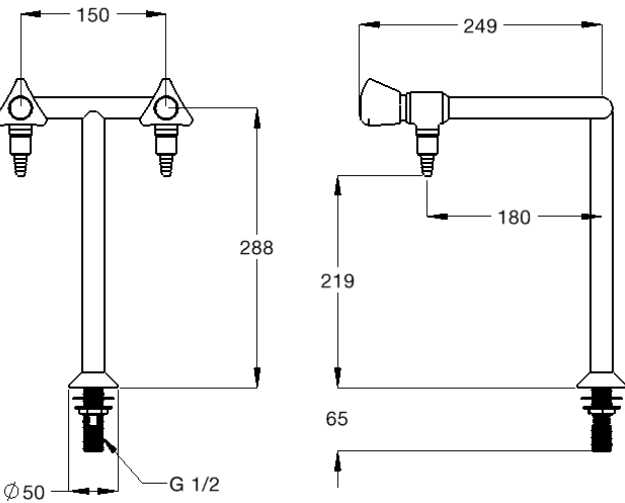

165.80.51.40

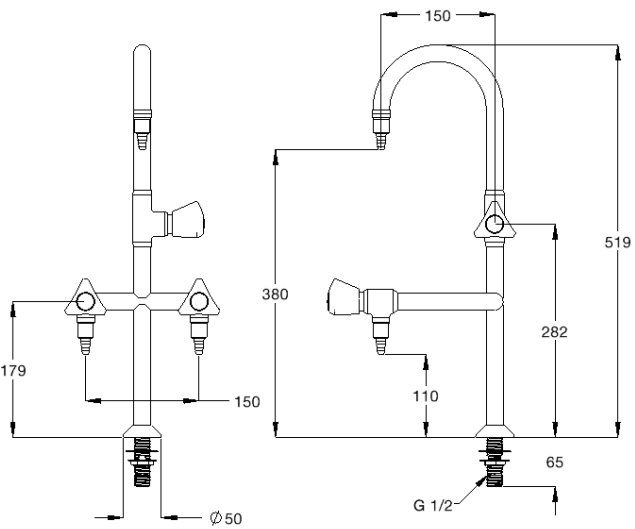

165.80.61.40

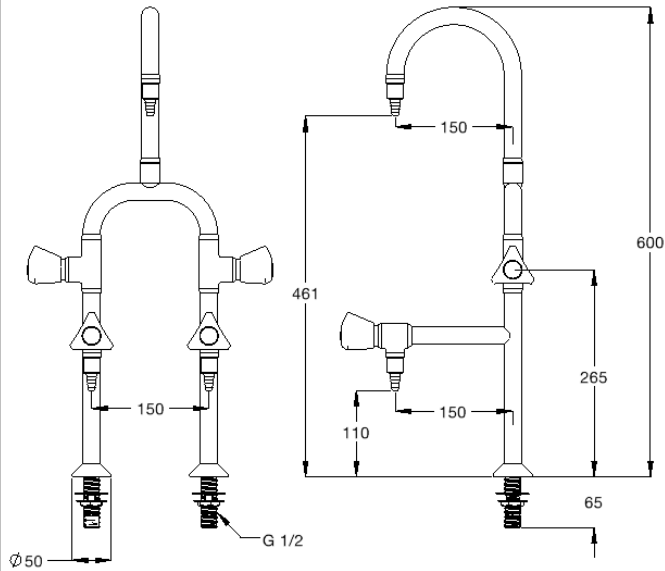

165.80.63.40

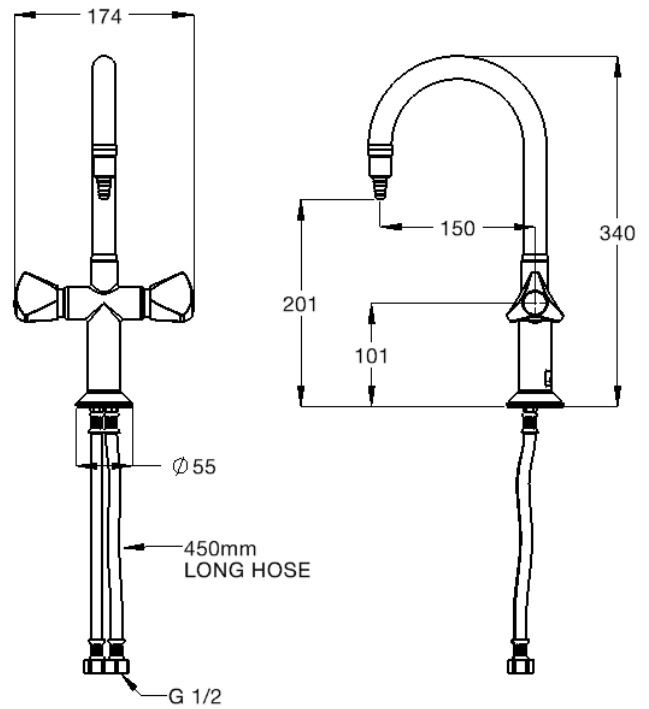

165.81.01.40

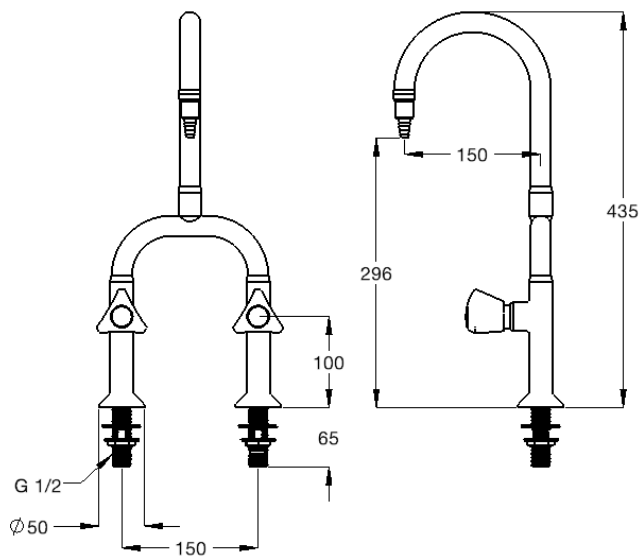

165.82.01.40

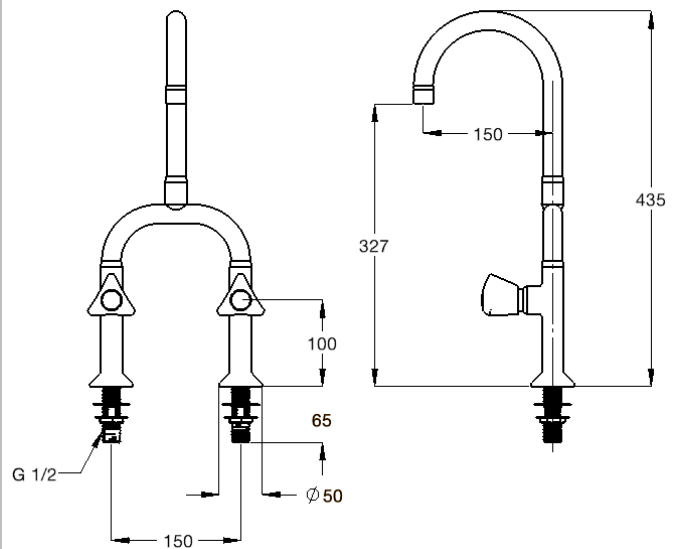

165.82.02.40

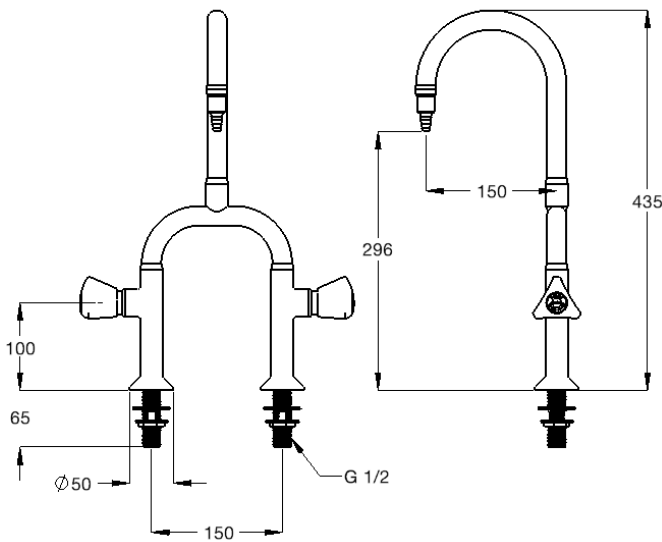

165.83.01.40

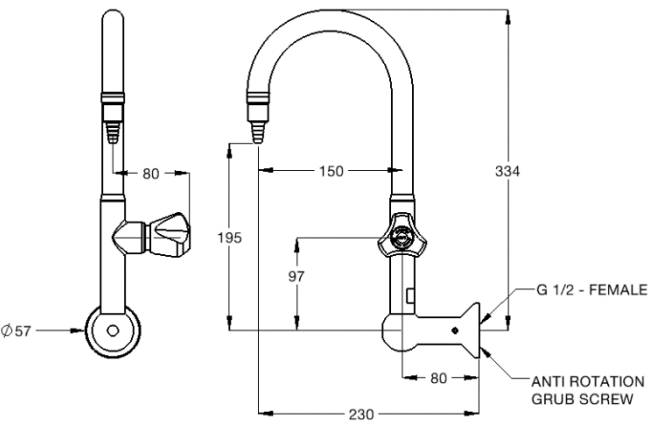

165.84.01.40

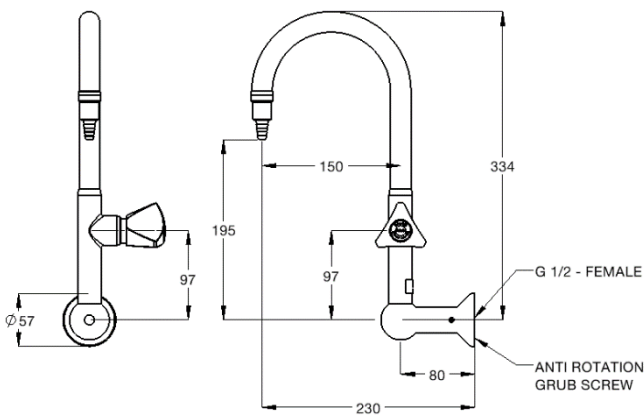

165.84.11.40

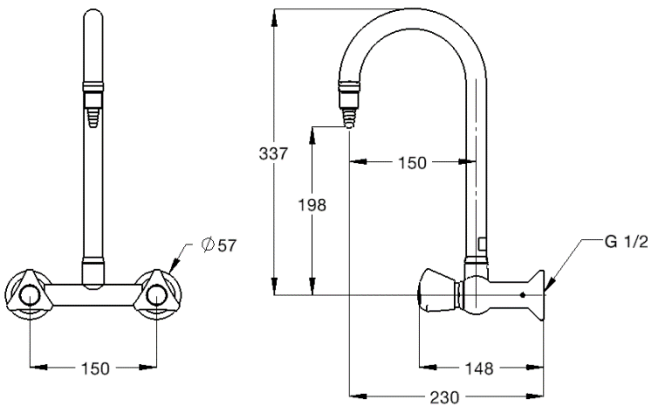

165.87.01.40

INSTALLATION

INSTALLATION COMPLIANCE: Galvin Engineering products must be installed in accordance with these installation instructions and in accordance with AS/NZS 3500, the PCA and your local regulatory requirements. Water and/or electrical supply conditions must also comply to the applicable national and/or state standards. Failing to comply with these provisions shall void the product warranty and may affect the performance of the product.

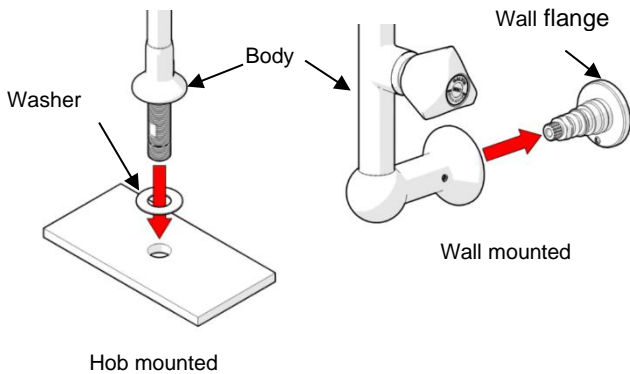

1. Fit tap set body

- Fit the tap set into the bench or wall spud as shown in images. Ensure the washer is fitted prior to tap body. We recommend using thread tape or equivalent to ensure connections do not leak.

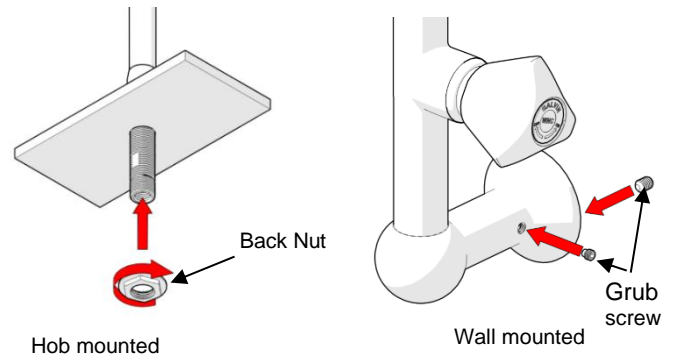

2. Secure the body

- For hob mounted type, secure the body underneath with the supplied backnut.
- For wall mounted type, secure the wall flange with the supplied grub screws.

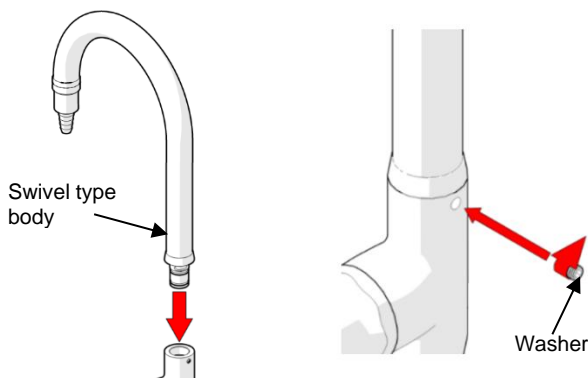

3. Insert Outlet (Swivel Body)

- If tap is swivel type, insert spout to the body and secure with grub screw.
- For fixed taps, outlet is already connected to the body.

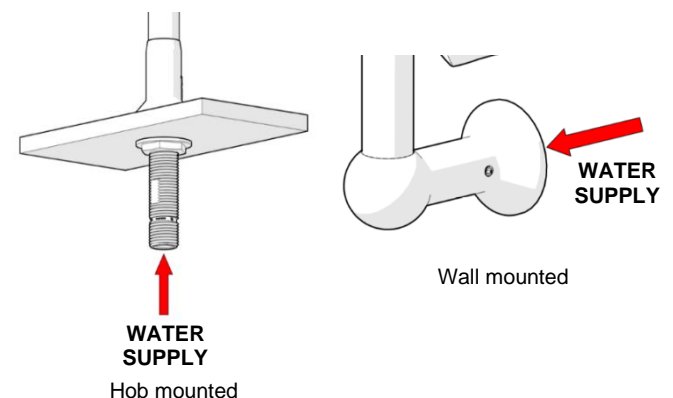

4. Connect the water line

- Connect water supply ensuring thread tape / sealant is used.

5. Testing

- Inspect the tap, check for any leaks, and check for correct operation.

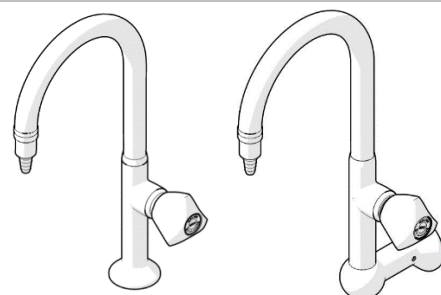

TROUBLESHOOTING

PROBLEM	CAUSE	RECTIFICATION
Water is not flowing or inconsistent flow	Blocked tube nozzle	Remove tube nozzle from outlet and remove debris. Install an in-line strainer to stop further blockages
	Flow regulators may be blocked	Remove flow regulators from inlet and remove debris
	Mains supply is turned off	Turn on mains supply

WARRANTY

The warranty set forth herein is given expressly and is the only warranty given by the Galvin Engineering Pty Galvin Engineering products are covered under our Manufacturer's Warranty. Galvin Engineering products must be installed in accordance with the installation instructions and in accordance with AS 3500 and NCC Volume Three, relevant Australian Standards and local authorities applicable to product being installed. Water and electrical supply conditions must also comply to the applicable national and/or state standards, failing to comply with these provisions may void the product warranty and affect performance of the product.

Please visit www.galvinengineering.com.au to view the full warranty, our Installation Compliance and Maintenance & Cleaning information as well as any other additional information.

Within Australia: **1300 514 074** Outside Australia: P: **+61 (0)8 9338 2344**

F: **+61 (0)8 9338 2340**

sales@galvinengineering.com.au

www.galvinengineering.com.au

ABN: 78 008 719 382

PERTH | SYDNEY | MELBOURNE | BRISBANE | ADELAIDE

